

Scheda tecnica Barre ALFA 500 S

Technical specification: ALFA 500 S Bar

Descrizione del prodotto / Description of the product

Barre ad aderenza migliorata di acciaio saldabile per cemento armato ottenuto con processo “Tempcore”.

Ribbed bars made of weldable steel for reinforced concrete, obtained using the Tempcore process.

Gamma dimensionale / Size range

Diametro: 8 – 32 mm / Diameter: 8–32 mm

Lunghezza: 6 - 20 m / Length: 6-20 m

Confezionamento / Packaging

Lunghezza fasci < 9 m n° 5 legature / 5 fastenings for bundle length < 9 m:

Lunghezza fasci da 9 a 14 m n° 7 legature / 7 fastenings for bundle length 9 to 14 m

Lunghezza fasci di 15 m n° 9 legature / 9 fastenings for bundle length 15 m

Lunghezza fasci da 16 a 20 m n° 11 legature / 11 fastenings for bundle length 16 to 20 m

Tutte le legature sono doppie con vergella diametro 7 mm / Double-strap fastening with 7 mm diameter wire

Etichettatura / Labelling

Ogni fascio è identificato con una etichetta metallica o plastificata che riporta le seguenti informazioni / Each bundle is identified with a metal or paper plastic label containing the following information:

logo azienda / company logo

numero di colata / heat number

diametro / diameter

tipo di acciaio / steel grade

data di produzione / production date

norme di riferimento / standards references

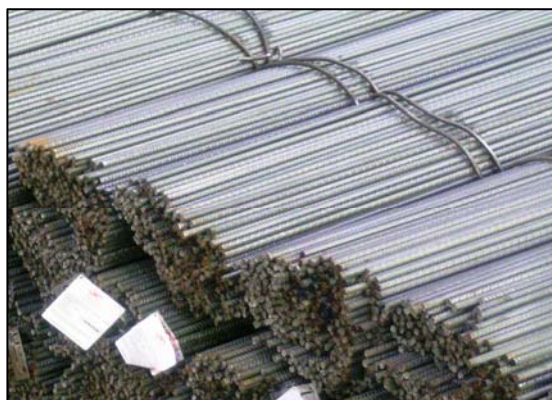

Geometria nervature e marchio di laminazione



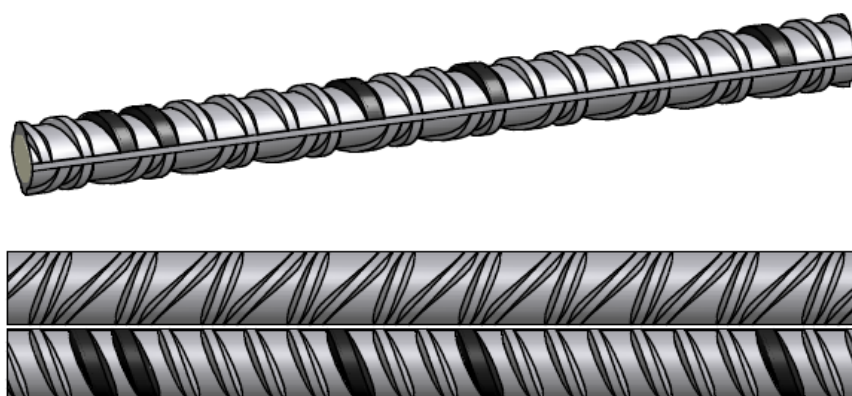



Ribs geometry and rolling mark



0 4 2 6

Scheda tecnica Barre ALFA 500 S

Technical specification: ALFA 500 S Bar

Qualifiche / Certifications							
Nazione <i>Country</i>	Italia <i>Italy</i>	Francia <i>France</i>	Germania <i>Germany</i>	Svizzera <i>Switzerland</i>	Romania <i>Romania</i>	Rep.Ceca <i>Cech. republic</i>	Slovenia <i>Sloven</i>
Ente Qualificazione <i>Certification body</i>	 Attestato n° 007/08-CA						

Conformità a norme / Conformity to Standards		
Nazione / <i>Country</i>	Norma / <i>standard</i>	Marca / <i>Grade</i>
ITALIA / <i>ITALY</i>	D.M. 14/01/2008	B 450 C
FRANCIA / <i>FRANCE</i>	NFA 35080/1	B 500 B
GERMANIA / <i>GERMANY</i>	DIN 488	B 500 B
ROMANIA / <i>ROMANIA</i>	DIN 488	B 500 B (Bst 500 S)
REP. Ceca / <i>CECH REPUBLIC</i>	DIN 488	B 500 B
SVIZZERA / <i>SWITZERLAND</i>	SIA 262	B 500 B
GRECIA / <i>GREECE</i>	ELOT 1421-3	B 500 C
SPAGNA / <i>SPAIN</i>	UNE 36068	B 500 S
REGNO UNITO / <i>UNITED KINGDOM</i>	BS 4449	B 500 B
PORTOGALLO / <i>PORTUGAL</i>	LNEC E450	A 500 NR
SLOVENIA / <i>SLOVEN</i>	SIST EN 10080	B 500 B
USA / <i>USA</i>	ASTM A615	GRADO 60 / 40
ISRAELE / <i>ISRAEL</i>	IS 4466	S400

Composizione chimica / Chemical composition					
C % max	P % max	S % max	Cu % max	N % max	Ceq. Max
0.22	0.050	0.050	0.80	0.012	0.50
(0.24)	(0.055)	(0.055)	(0.85)	(0.014)	(0.52)

I valori tra parentesi si applicano per analisi sul prodotto/ *The figures in brackets apply to product analysis*

Proprietà meccaniche / Mechanical properties							
Norma <i>Standard</i>	Marca <i>Grade</i>	Re N/mm ²	Rm N/mm ²	Rm/Re	Agt %	A5 %	A10 %
D.M. 14/01/2008	B450 C	≥ 450	≥ 540	≥ 1.15 - ≤ 1.35	≥ 7.5		
NFA 35080/1	B 500 B	≥ 500		≥ 1.08	≥ 5		
SIA 262	B 500 B	≥ 500		≥ 1.08	≥ 5		
DIN 488	B500B (Bst 500 S)	≥ 500		≥ 1.08	≥ 5		
DIN 488	B 500 B	≥ 500		≥ 1.08	≥ 5		
ELOT 1421-3	B 500 C	≥ 500		≥ 1.15 - ≤ 1.35	≥ 7.5		
UNE 36068	B 500 S	≥ 500		≥ 1.08	≥ 5		
BS 4449	B 500 B	≥ 500		≥ 1.08	≥ 5		
LNEC E450	A 500 NR	≥ 500		≥ 1.08	≥ 5		
SIST EN 10080	B 500 B	≥ 500		≥ 1.08	≥ 5		
ASTM A615	GR. 60	≥ 420	≥ 620	≥ 1.10			≥ 9
IS 4466	S400	≥ 400	≥ 500	≥ 1.25			≥ 12