

## Scheda tecnica Rocchettato ALFA 500 KS *Technical specification: ALFA 500 KS Spooled Coil*

### **Descrizione del prodotto / Description of the product**

Rocchetto ad aderenza migliorata di acciaio saldabile per cemento armato laminato a caldo con trattamento termico “Tempcore”

*Ribbed spooled coil made of weldable steel for reinforced concrete, hot rolled using the Tempcore process.*

### **Gamma dimensionale / Size range**

Diametro 8-16 mm / *Diameter: 8–16 mm*

### **Confezionamento / Packaging:**

In bobine reggettate su 4 posizioni / *In spooled coils fastened in 4 points*

Peso di ogni bobina ca. 3000 kg / *Approx. weight of each spooled coil 3000 kg*

### **Dimensioni bobina: Coil size**

Diametro esterno: 1100-1200 mm / *Outside diameter: 1100-1200 mm*

Diametro interno: 700 mm / *Inside diameter: 700 mm*

Altezza: 700 mm / *Height: 700 mm*

### **Etichettatura / Labelling**

Ogni bobina è identificata con una etichetta plastificata che riporta le seguenti informazioni / *Each spooled coil is identified with a plastified label containing the following information:*

logo azienda / *company logo*

numero di colata / *heat number*

diametro / *diameter*

tipo di acciaio / *steel grade*

data di produzione / *production date*

norme di riferimento / *standards references*





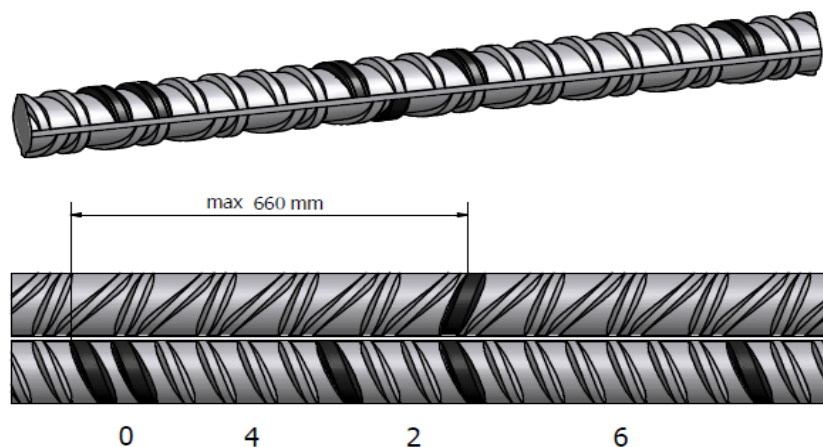

### **Geometria nervature e Marchio di laminazione**

#### *Ribs geometry and rolling mark*



## Scheda tecnica Rocchettato ALFA 500 KS

### Technical specification: ALFA 500 KS Spooled Coil

<b>Qualifiche / Certifications</b>						
Nazione <i>Country</i>	Italia <i>Italy</i>	Germania <i>Germany</i>	Svizzera <i>Switzerland</i>	Romania <i>Romania</i>	Rep.Ceca <i>Cech. Rep.</i>	Slovenia <i>Sloven</i>
Ente Qualificazione <i>Certification body</i>	 Attestato n° 008/08-CA					

<b>Conformità a norme / conformity to standards</b>		
Nazione/Country	Norma/Standard	Marca/Grade
ITALIA / ITALY	D.M. 14/01/2008	B 450 C
FRANCIA / FRANCE	NFA 35080	B 500 B
GERMANIA / GERMANY	DIN 488	B 500 B
ROMANIA / ROMANIA	DIN 488	B 500 B (Bst 500 S)
REP. CECA / CEC REPUBLIC	DIN 488	B 500 B
SVIZZERA / SWITZERLAND	SIA 262	B 500 C
GRECIA / GREECE	ELOT 1421-3	B 500 C
SPAGNA / SPAIN	UNE 36068	B 500 S
REGNO UNITO / UNITED KINGDOM	BS 4449	B 500 B
PORTOGALLO / PORTUGAL	LNEC E450	A 500 NR
SLOVENIA / SLOVEN	SIST EN 10080	B 500 B
USA / USA	ASTM A615	GRADO 60

<b>Composizione chimica / Chemical composition</b>					
C % max	P % max	S % max	Cu % max	N % max	Ceq. Max
0.22	0.050	0.050	0.80	0.012	0.50
(0.24)	(0.055)	(0.055)	(0.85)	(0.014)	(0.52)

I valori tra parentesi si applicano per analisi sul prodotto/ The figures in brackets apply to product analysis

<b>Proprietà meccaniche / Mechanical properties</b>						
Norma <i>Standard</i>	Marca <i>Grade</i>	Re N/mm <sup>2</sup>	Rm N/mm <sup>2</sup>	Rm/Re	Agt %	A5 %
D.M. 14/01/2008	B450 C	≥ 450	≥ 540	≥ 1.15 - ≤ 1.35	≥ 7.5	
NFA 35080	B 500 B	≥ 500		≥ 1.08	≥ 5	
SIA 262	B 500 C	≥ 500		≥ 1.15 -≤ 1.35	≥ 7.5	
DIN 488	B500B (Bst 500 S)	≥ 500		≥ 1.08	≥ 5	
DIN 488	B 500 B	≥ 500		≥ 1.08	≥ 5	
ELOT 1421-3	B 500 C	≥ 500		≥ 1.15 -≤ 1.35	≥ 7.5	
UNE 36068	B 500 S	≥ 500	≥ 550	≥ 1.05	≥ 5	≥ 12
BS 4449	B 500 B	≥ 500		≥ 1.08	≥ 5	
LNEC E450	A 500 NR	≥ 500	≥ 550	≥ 1.08	≥ 5	
SIST EN 10080	B 500 B	≥ 500		≥ 1.08	≥ 5	
ASTM A615	GR. 60	≥ 420	≥ 620	≥ 1.10		